

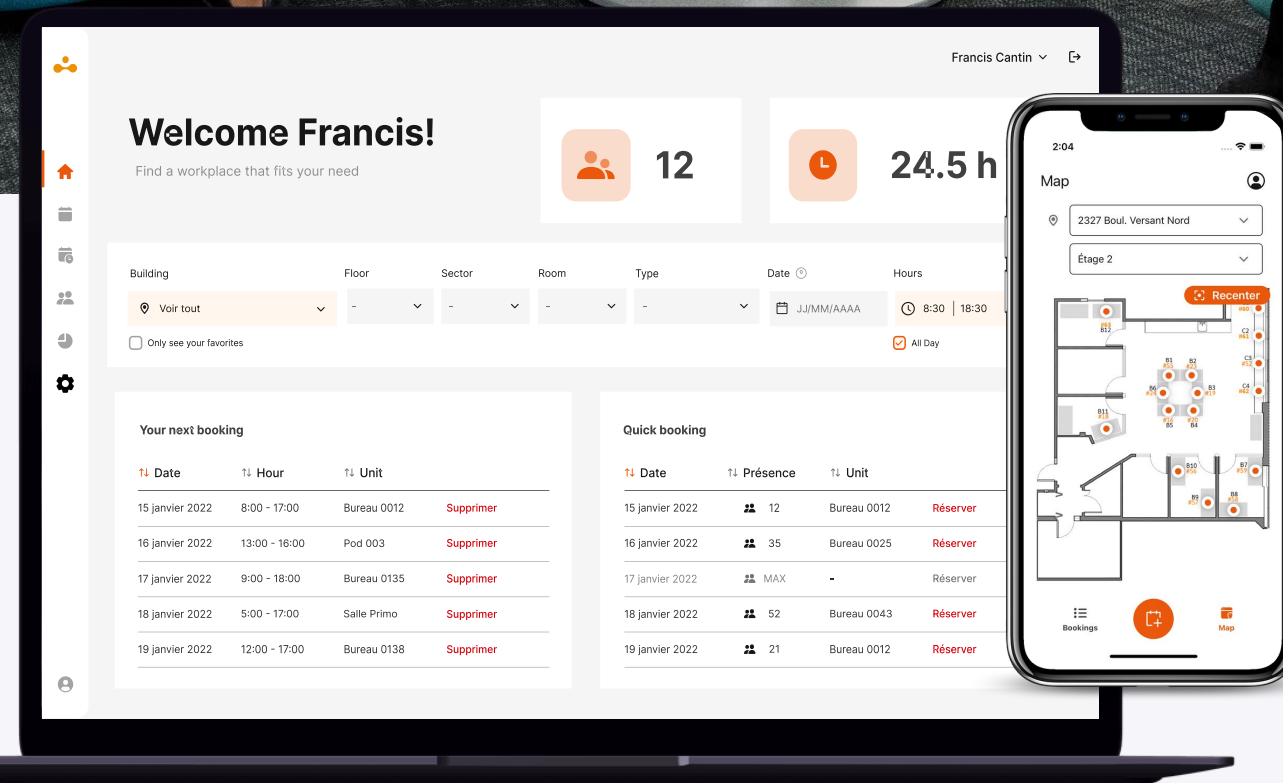

Smart Workplace Management Platform, Encouraging the Return of Teams to the Office

artopex®



Welcome Francis!

Find a workplace that fits your need

12

24.5 h

Building Floor Sector Room Type Date Hours
Voir tout - - - - JJ/MM/AAAA 8:30 | 18:30
Only see your favorites All Day

Your next booking

Date	Hour	Unit	
15 janvier 2022	8:00 - 17:00	Bureau 0012	Supprimer
16 janvier 2022	13:00 - 16:00	Pod 003	Supprimer
17 janvier 2022	9:00 - 18:00	Bureau 0135	Supprimer
18 janvier 2022	5:00 - 17:00	Salle Primo	Supprimer
19 janvier 2022	12:00 - 17:00	Bureau 0138	Supprimer

Quick booking

Date	Présence	Unit	
15 janvier 2022	12	Bureau 0012	Réserver
16 janvier 2022	35	Bureau 0025	Réserver
17 janvier 2022	MAX	-	Réserver
18 janvier 2022	52	Bureau 0043	Réserver
19 janvier 2022	21	Bureau 0012	Réserver

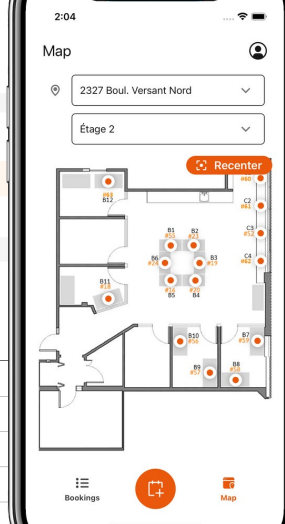

Bookings

The screenshot displays the 'Réservation' (Reservation) interface. At the top, it shows the user's name 'Francis Cantin' and a search prompt 'Sélectionner les critères de recherche'. Below this are several filter categories: 'Bâtiment' (Building) with a dropdown for 'Bâtiment 1, Bâtiment 2'; 'Étage' (Floor) with a dropdown for 'Tous'; 'Secteur' (Sector), 'Salle' (Room), and 'Type' (Type) with dropdown menus; 'Date' (Date) set to '12 janvier 2021'; and 'Heure' (Time) set to '8:30 | 18:30'. There are also checkboxes for 'Voir uniquement mes favoris' and 'Toute la journée'. A search icon is on the right. Below the filters, it says 'Vos résultats de recherche' and 'Afficher uniquement les places disponibles' with a toggle switch. The main area shows a floorplan map for 'Bâtiment 1' with 'Étage 2' selected. The map displays various desks and meeting areas, some marked with orange dots indicating availability or booking status. A sidebar on the left contains navigation icons for home, calendar, and settings.



Hot Desk Booking

ELIA allows employees to book a workspace adapted to their needs via an interactive floorplan.



Dynamic Map

With just a few clicks, ELIA allows you to locate colleagues and book a space with or near them, encouraging in-person collaboration.



Space Management

Managers can access booking data in order to properly plan the distribution of furniture or the use of spaces.

Bookings

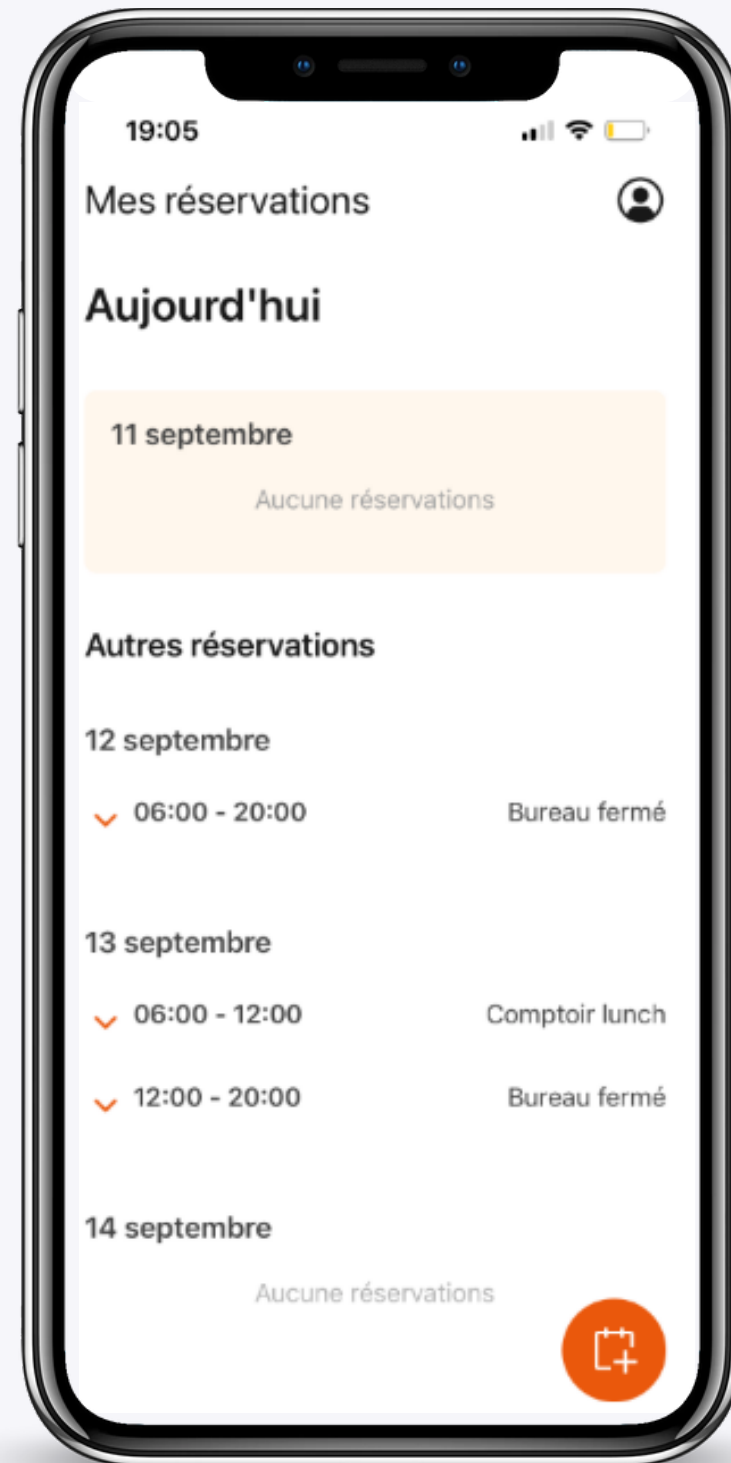

Make Bookings on the Go

The ELIA mobile app allows employees to book a workspace in a user-friendly way while on the go. The mobile app also allows employees to locate their colleagues within the office in real time.



Available on Popular Platforms

The Elia app is available via iOS and Android platforms.

Collaboration



Find Colleagues



Encourage Return to the Office

ELIA was specifically designed to facilitate in-person collaboration within hybrid workplaces.

Thanks to its smart notifications, ELIA allows colleagues to synchronize in-office days in a convenient manner, encouraging employee return to office.



ELIA

Olivia Brooks just booked a desk for Tuesday & Friday

5m ago

Hi Isabelle,

57% of your teammates will be at the office on **Monday** and **Thursday**. Want to join them?

[I am in!](#)

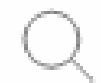

Search your colleague



Collaboration

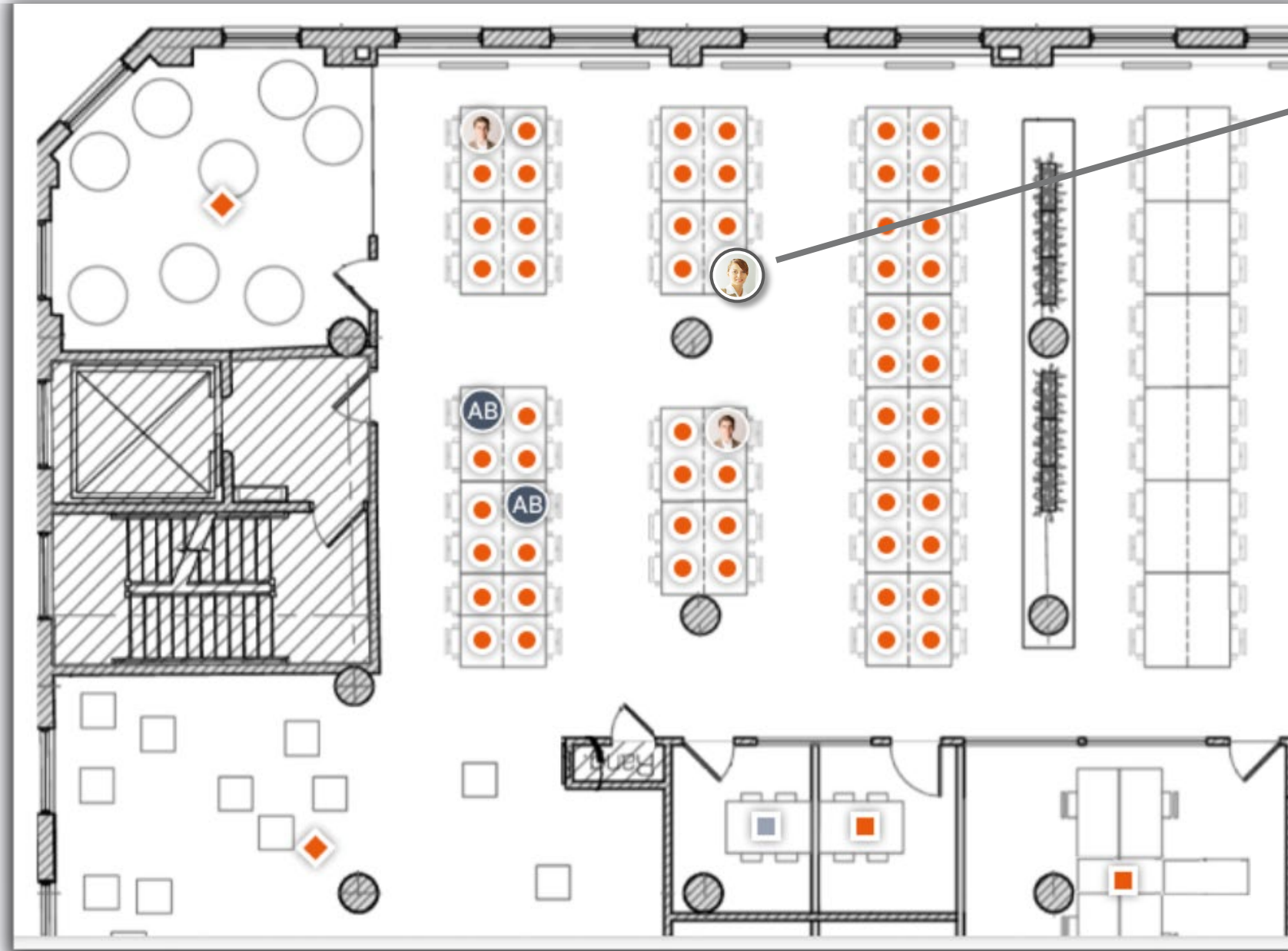

Marcia Lewis
Financial Director
Office 4D



Find Colleagues Via Interactive Maps

With the interactive office map, employees can locate their colleagues both in real time and through upcoming bookings, encouraging the return of the work teams to the office.

Occupancy



Employees
on-site

74



+4 compared to
yesterday



Available meeting
rooms

2



- 4 compared to
yesterday



Workplace
occupancy

67%



+2,4% compared to
yesterday



Analyse Occupancy Data



Centralized IoT Hub

The data collected through the platform allows ELIA to analyze workplace occupancy and decipher trends.

This helps companies better understand their employees' habits and adapt office spaces to better suit their needs.

Let's Connect Your
Resources to Your
Infrastructure.



elia

artopex®